



C-THRU™ 50G

INSTRUCTION MANUAL

Ensure that all relevant personnel read the points listed within this leaflet and that a copy is given to staff involved with the installation and maintenance of this product. Glasdon recommends that a full Health and Safety analysis is carried out prior to installation.

CONTENTS

KIT CONTENTS	NON LOCKING C-THRU 50G MODEL	PAGE 1
KIT CONTENTS	LOCKING C-THRU 50G MODEL	PAGE 2
ASSEMBLY INSTRUCTIONS	NON LOCKING / LOCKING C-THRU 50G MODEL	PAGE 2
GROUND FIXING INSTRUCTIONS	NON LOCKING / LOCKING C-THRU 50G MODEL	PAGE 4

STANDARD NON LOCKING C-THRU 50G

DIAGRAM NOT TO SCALE

KIT CONTENTS:

- ITEM 1** - Hood x 1
- ITEM 2** - Polycarbonate Body x 1
- ITEM 3** - Base x 1
- ITEM 4** - Nylon Rivet x 3
- ITEM 5** - Base Plug x 3

TOOLS REQUIRED:

- Phillips Head Screwdriver x 1

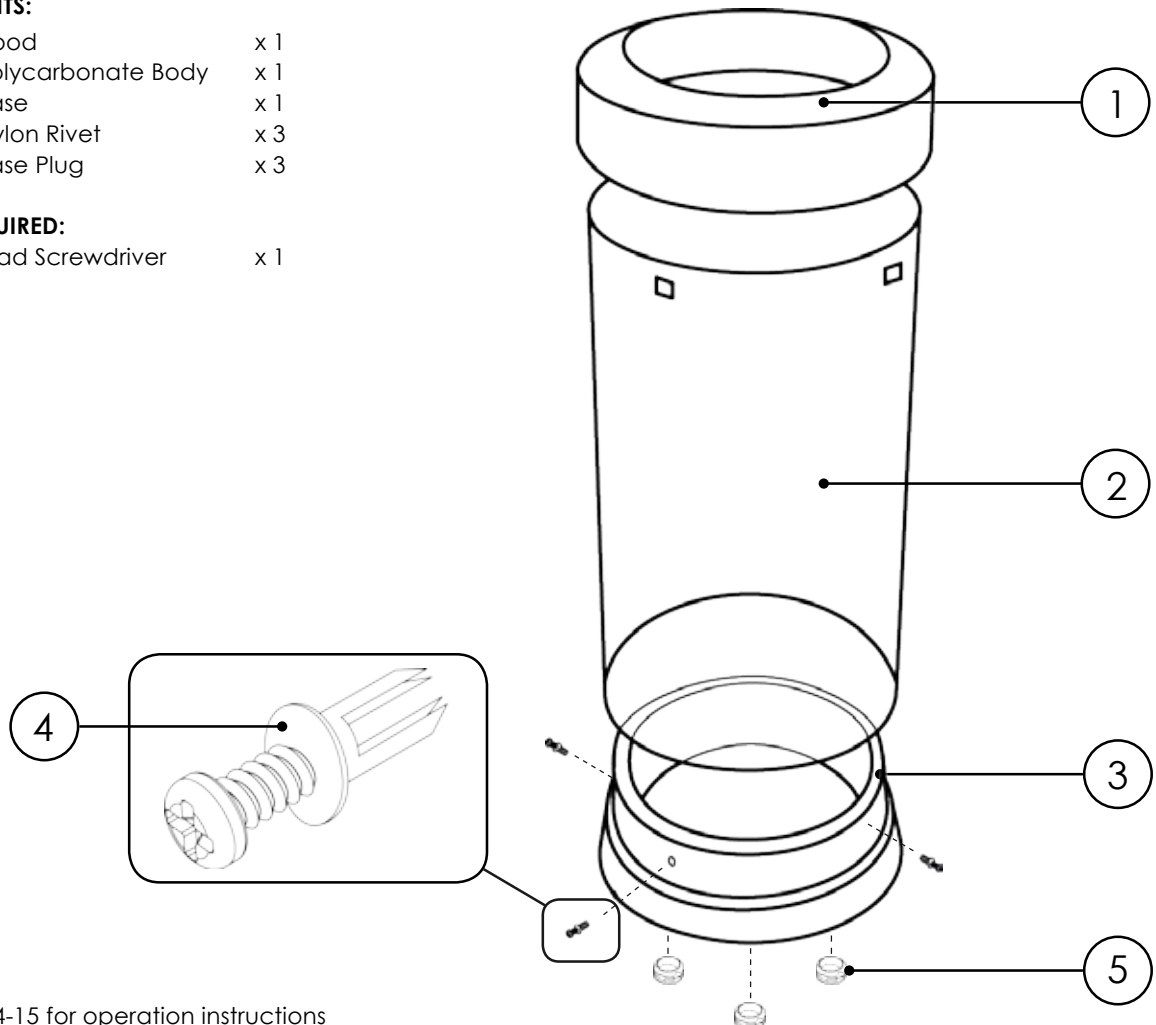

See steps 14-15 for operation instructions

LOCKING MODEL C-THRU 50G

DIAGRAM NOT TO SCALE

KIT CONTENTS:

ITEM 1	- Hood	x 1
ITEM 2	- Polycarbonate Body	x 1
ITEM 3	- Blase	x 1
ITEM 4	- Nylon Rivet	x 3
ITEM 5	- Base Plug	x 3
ITEM 6	- Lock Kit (attached)x 1	
ITEM 7	- Bobbin Part A	x 3
ITEM 8	- Bobbin Part B	x 3
ITEM 9	- Screw M5	x 3
ITEM 10	- Glasdon Tri Key	x 1

TOOLS REQUIRED:

- Phillips Head screwdriver

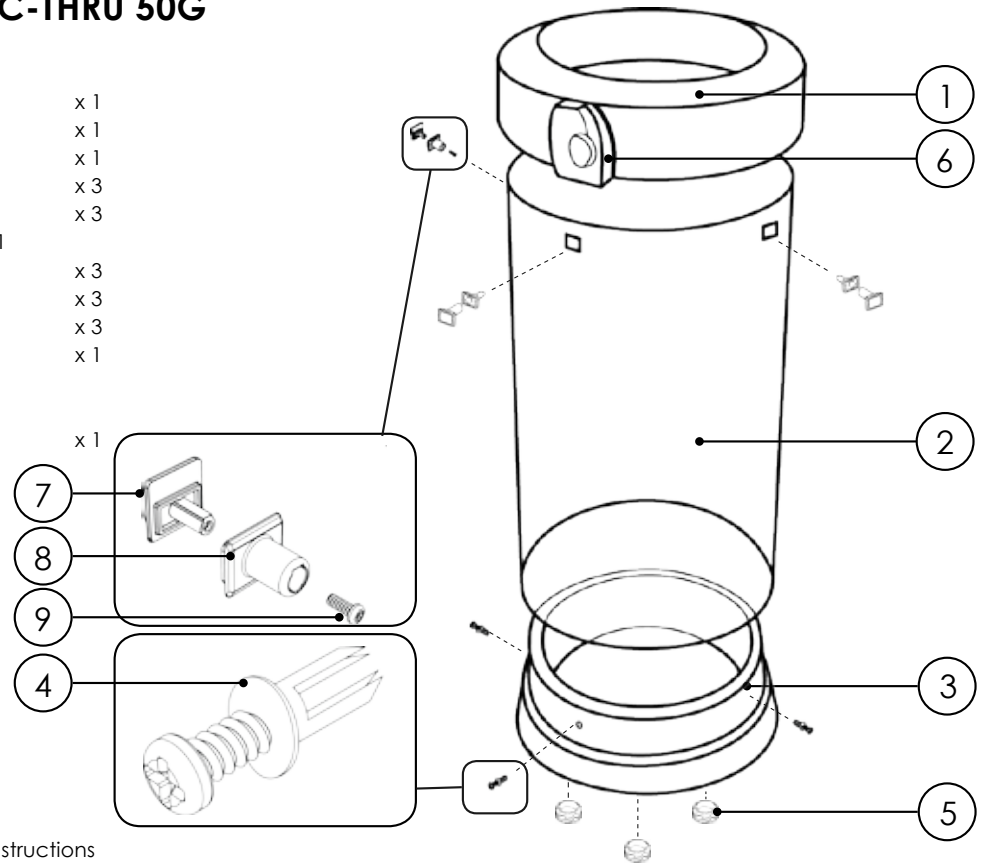

See steps 10-14 for operation instructions

ASSEMBLY INSTRUCTIONS (If received in flat pack form)

If the unit has been supplied without a lock complete steps 5-10,14,15

If the unit has been supplied with an attached lock kit complete steps 5-14,16-18

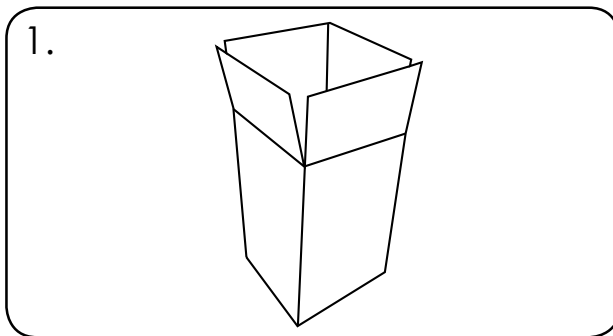

1. Open top of box.

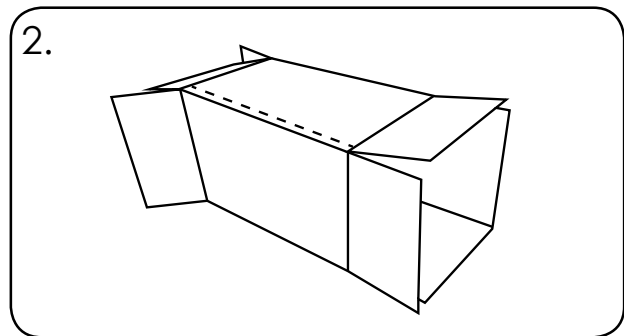

2. Lie box on side, with the dotted line to the top. Open the bottom of the box.

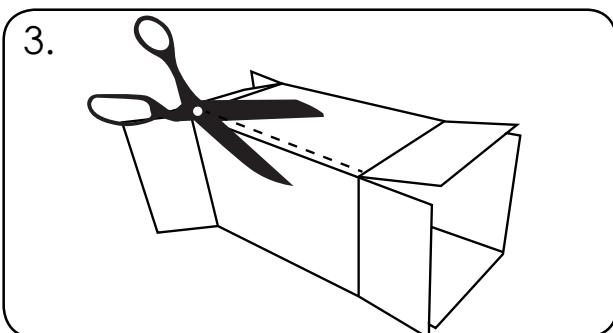

3. Carefully cut box open along the dotted line to avoid damaging the contents.

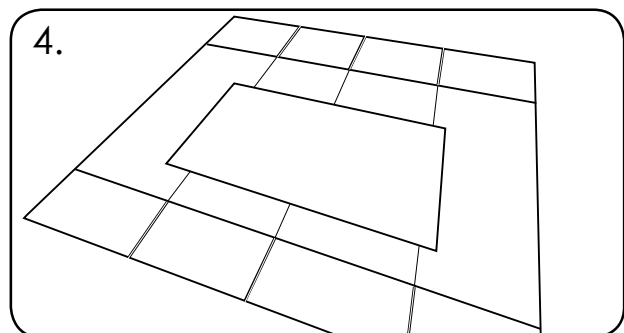

4. Allow box to spring open and the packaged polycarbonate sheets to unfurl.

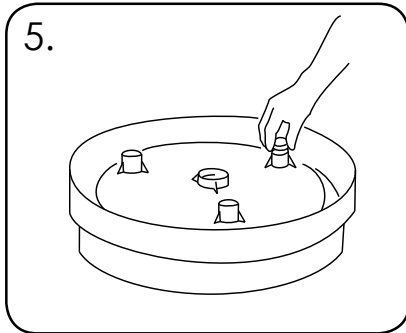

5. Overturn the Base (ITEM 3) and insert the 3 x Base Plugs (ITEM 5) into the 3 x plug locations, (if required).

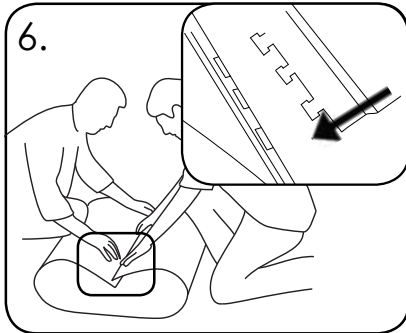

6. Take each end of the Polycarbonate Body (ITEM 2) and fold over so the joint feature is facing outwards. Align the tabs with the slots at 90°. Fully insert the tabs into the slots. The Body will now be a tube shape.

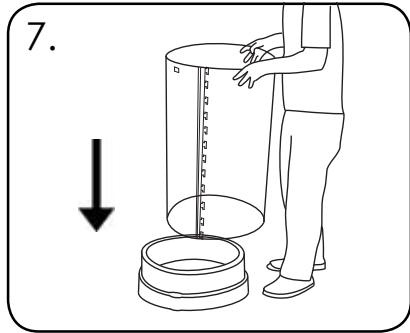

7. Peel the protective plastic wrap off the Polycarbonate Body. Place the body onto the Base.

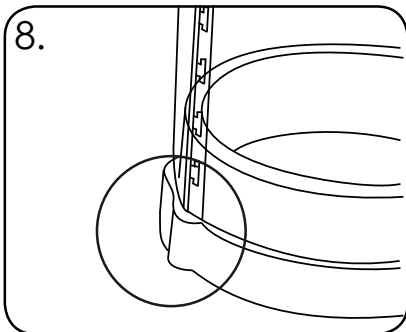

8. Align the joint section on the Body with the local area on the Base as circled above.

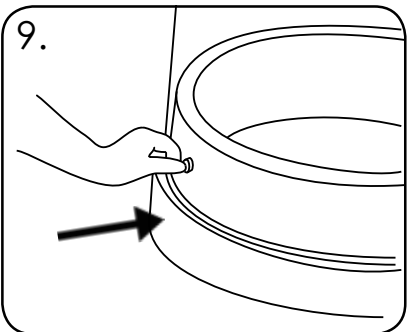

9. Push the 3 x Nylon Rivets (ITEM 4) into the 3 x fixing holes in the Body.

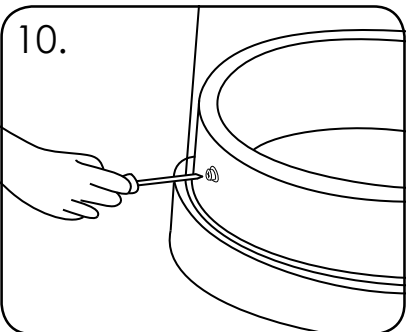

10. Using a Phillips head screwdriver fasten the 3 x Rivets to the Body.

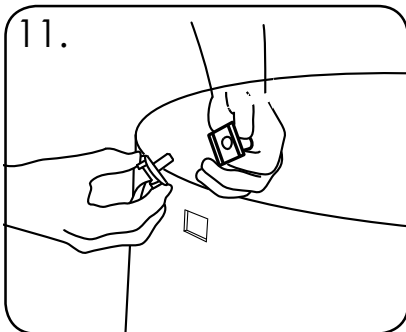

11. Attach the Bobbin on to the Body as shown above connecting Part A (ITEM 7) with Part B (ITEM 8), Ensure the flat face on Part A is facing upwards and Part B is facing into the polycarbonate body. See diagram on page 2 for detailed assembly of bobbin.

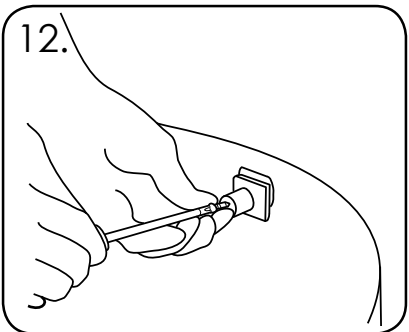

12. Insert the M5 Screw (ITEM 9) into Bobbin Part B and tighten using a Phillips head screwdriver.

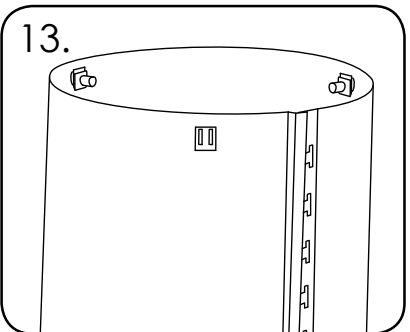

13. Repeat steps 11-12 for the 3 sets of Bobbins.

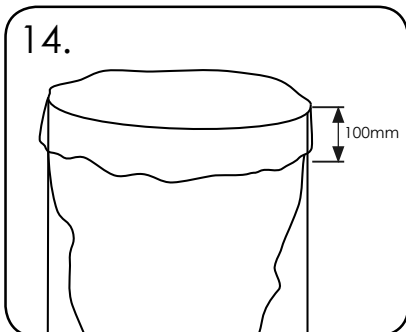

14. Place a clear sack into the Body and hook over the rim with approximately 100mm overhang, on the outside of the body.

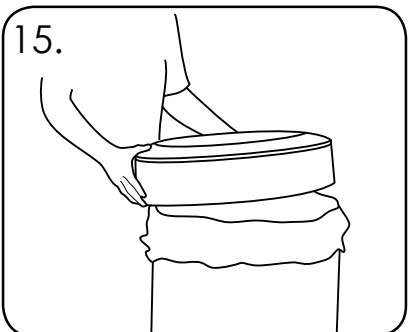

15. Place the Hood (ITEM 1) onto the Polycarbonate Body.

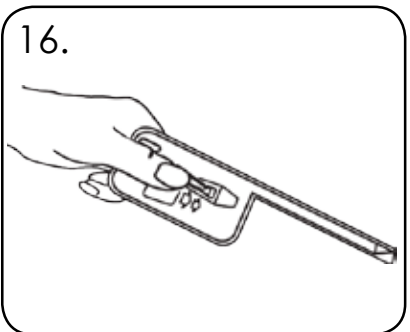

16. When inserting the Key (ITEM 10), Ensure the illustration faces upward.

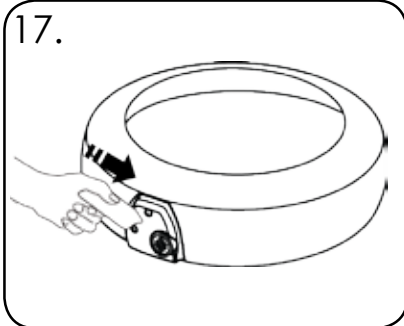

17. Insert the Key all the way into the lock on the Hood (do not turn the Key). This will automatically release the locking mechanism.

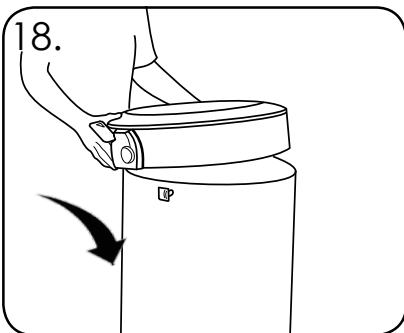

18. With the Key still in position, offer the Hood onto the Body aligning the Lock with the rear Bobbin. When aligned turn the Hood clockwise then remove Key.

To disassemble product, follow steps 5-18 in reverse order.

GROUND FIXING INSTRUCTIONS

KIT CONTENTS:

ITEM 11 - Ground Fixing Peg x 3

TOOLS REQUIRED:

- Mallet x 1
- Phillips Head Screwdriver x 1

Removing the polycarbonate body will allow for ease of installation; Refer to diagrams 10 & 7 in the assembly instructions.

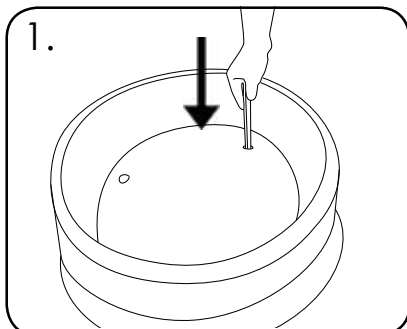

1. Insert the Ground Fixing Peg (ITEM 11) through the pre drilled hole in the Base into soft ground beneath.

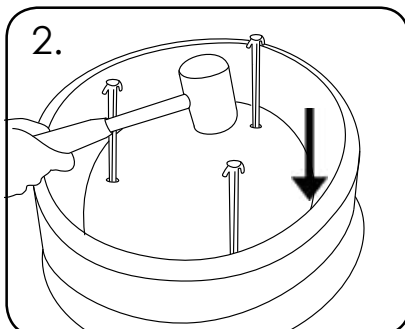

2. Repeat step 1 for the 3 x Ground Fixing Pegs. Using a Mallet force the 3 x Pegs into the ground fully.

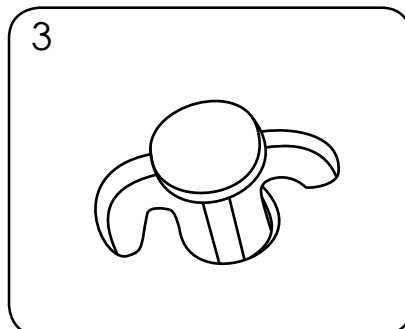

3. Ensure only the head of each Ground Fixing Peg is showing in the Base.

IMPORTANT NOTE: PLEASE ENSURE THAT ALL RELEVANT PERSONNEL READ THE POINTS LISTED WITHIN THIS LEAFLET AND THAT A COPY IS GIVEN TO STAFF INVOLVED WITH THE INSTALLATION AND MAINTENANCE OF THIS PRODUCT.

SAFETY NOTE: PLEASE REFER TO 'THE MANUAL HANDLING OPERATIONS REGULATIONS 1992' DURING HANDLING.

 **Glasdon**®, C-Thru are trademarks or registered trademarks of GLASDON GROUP or its subsidiaries in the UK and other countries.

A planned maintenance schedule or regular inspection is recommended, replacing components as necessary.

Replacement components are available direct from GLASDON.

GLASDON cannot be held responsible for claims arising from incorrect installation, unauthorised modifications or misuse of the product.

Issue 1 - October 2016 - Stock No. C000/0487-US DWG No. 07B-357-29

© Copyright 01/2017. Glasdon, Inc reserve the right to alter price and specification without prior notice. PN/

 **Glasdon**®
Glasdon, Inc.
5200D Anthony Road
Sandston, VA 23150

Sales Inquiries: 1-855-USGLASDON

General Inquiries: 804-726-3777

Fax: 804-726-3778

E-mail: info@glasdon.com

Web: www.glasdon.com